



**BISON**



**BISON... Better Than Ever!**

# Welcome to Bison Trailers!

## OUR HISTORY

Bison has been manufacturing living quarter horse trailers since its inception in 1984. Bison managed to become an industry leader while having the ability as well as resources needed to produce a quality product in one standalone facility and without the need for outsourcing. Today, our Bison team is stronger and more committed than ever to producing trailers that measure up to the expectations of our customers while providing a lifetime of lasting memories.



## OUR PRODUCTS

For nearly 40 years, we've understood that our customers come first as you are the reason that we are in business. Bison remains committed to offering a quality living quarter horse trailer in either a steel or aluminum frame, both designed to fit your lifestyle. Whether you require a 7' wide, 8' wide, or 8.5' Wide-Body LQ trailer, Bison has you covered. Each trailer is backed with a straightforward warranty along with a national dealer and service network that you can rely on.





# 102 WIDE-BODY



## HORSE HAULER

SV8.517-4-HORSE



SV8.517-3-HORSE

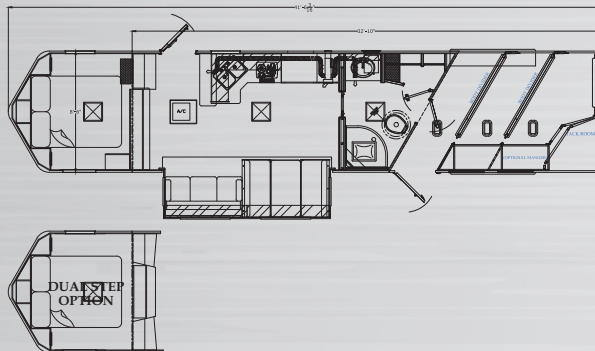

## TOY HAULER

SV8.517-4-HORSE

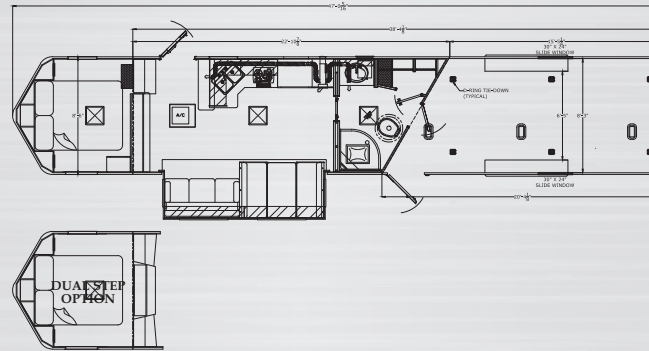

## STANDARDS AND FEATURES

- 3-WAY SWITCH FOR HORSE AREA
- 30 AMP SERVICE w/DETACHABLE 30 AMP POWER CORD
- 60/40 REAR LOAD DOORS
- 8000# AXLES
- ADJUSTABLE SADDLE TREE
- ALUMINUM AIR FLOW DIVIDERS
- BRIDLE HOOKS
- BRITE NOSE – FRONT PANEL
- DROP DWN ESCAPE DOOR WINDOW
- DROP FEED WINDOWS
- EXTERIOR WATER SPIGOT (N/A 6' LAYOUT)
- EXTRUDED ALUMINUM PLANK HORSE AREA FLOORING
- FURNACE, 18,000 BTU
- GLASS SHOWER DOOR
- LED EXTERIOR LIGHTS
- LED LIGHTING THROUGHOUT
- LP TANKS (2) w/DUAL REGULATOR
- MANUAL JACK – 2 SPEED
- MICROWAVE
- PORCELAIN TOILET
- RADIUS SHOWER w/DUAL CONTROL HANDLES
- REAR LOAD LIGHT (1)
- RECESSED COOK TOP w/RANGE HOOD
- REFRIGERATOR
- RESIDENTIAL FAUCETS
- RV DOOR LATCH (@ ESCAPE DOOR)
- SHIRT CLOSET(S) w/MIRRORED INSERTS IN BEDROOM
- SINK COVERS
- SKYLIGHT IN SHOWER
- SLIDING WINDOW ON HIP SIDE EACH STALL
- 215/75R17.5LRH TIRES w/BLACK ALUM WHEELS
- STEP (AT ENTRANCE DOOR)
- SPARE TIRE AND RIM
- STAINLESS STEEL KITCHEN SINK
- TV/RADIO ANTENNA
- TWO BATTERIES, GRP 24 w/SHUT-OFF
- UPGRADED COUNTER TOP THROUGHOUT
- UPGRADED FLOOR COVERING THROUGHOUT
- UPGRADED GRAPHICS PACKAGE
- VINYL VALANCES w/ROLLER SHADES
- WATER HEATER GAS DSI (6 GAL)
- WHITE EXTERIOR
- XL TV UPGRADE (16' LIVING ENT. FLOORPLAN ONLY)

**BISON**





# 8' WIDE



## STANDARDS AND FEATURES

- 3-WAY SWITCH FOR HORSE AREA
- 30 AMP SERVICE w/DETACHABLE 30 AMP POWER CORD
- 60/40 REAR LOAD DOORS
- 7000# AXLES
- ADJUSTABLE SADDLE TREE
- ALUMINUM AIR FLOW DIVIDERS
- BRIDLE HOOKS
- BRITE NOSE - FRONT PANEL
- DROP DWN ESCAPE DOOR WINDOW
- DROP FEED WINDOWS
- EXTERIOR WATER SPIGOT (N/A 6' LAYOUT)
- EXTRUDED ALUMINUM PLANK HORSE AREA FLOORING
- FURNACE, 18,000 BTU
- GLASS SHOWER DOOR
- LED EXTERIOR LIGHTS
- LED LIGHTING THROUGHOUT
- LP TANKS (2) W/ DUAL REGULATOR
- MANUAL JACK- 2 SPEED
- MICROWAVE
- PORCELAIN TOILET
- RADIUS SHOWER W/DUAL CONTROL HANDLES
- REAR LOAD LIGHT (1)
- RECESSED COOK TOP W/ RANGE HOOD
- REFRIGERATOR
- RESIDENTIAL FAUCETS
- RV DOOR LATCH (@ ESCAPE DOOR)
- SHIRT CLOSET(S) W/MIRRORED INSERTS IN BEDROOM
- SINK COVERS
- SKYLIGHT IN SHOWER
- SLIDING WINDOW ON HIP SIDE EACH STALL
- ST235/85R16 LRG TIRES W/BLACK ALUM WHEELS
- STEP (AT ENTRANCE DOOR)
- SPARE TIRE & RIM
- STAINLESS STEEL KITCHEN SINK
- TV/RADIO ANTENNA
- TWO BATTERIES, GRP 24 W/ SHUT-OFF
- UPGRADED COUNTER TOP THROUGHOUT
- UPGRADED FLOOR COVERING THROUGHOUT
- UPGRADED GRAPHICS PACKAGE
- VINYL VALANCES W/ROLLER SHADES
- WATER HEATER GAS DSI (6 GAL)
- WHITE EXTERIOR
- XL TV UPGRADE (16' LIVING ENT. FLOORPLAN ONLY)

SV809B-SV809B

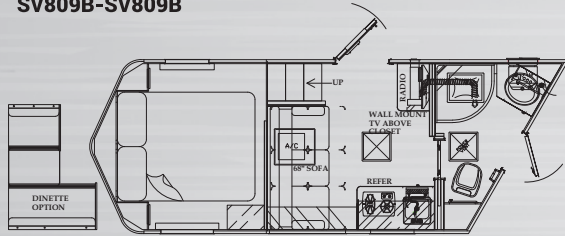

SV813B.S-SV813B

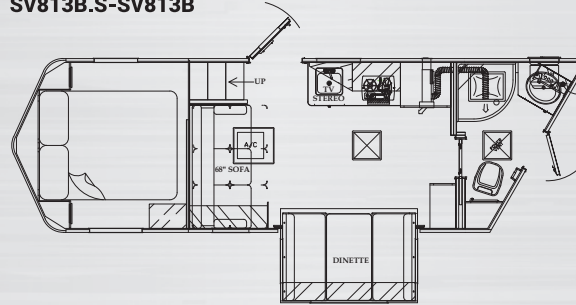

SV811.S-SV811

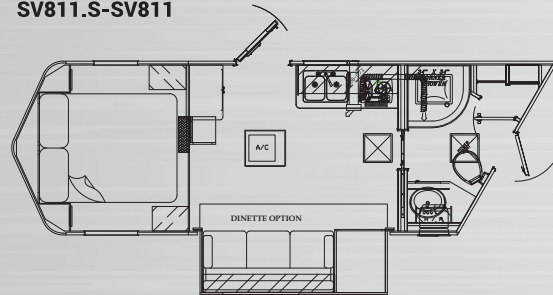

SV813G.S-SV813G

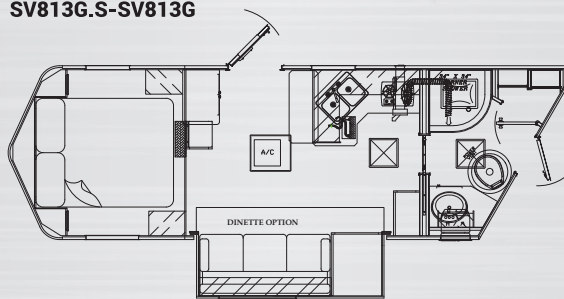

SV811B-SV811B

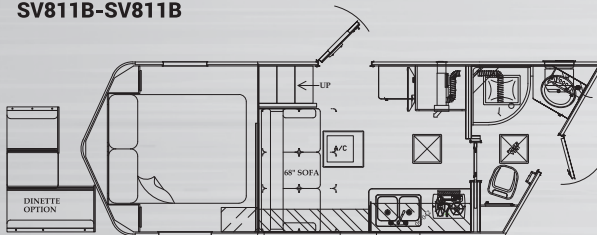

SV816.S-SV816

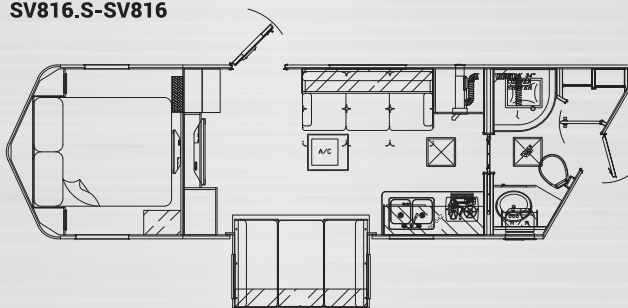

# SILVERADO 7' WIDE



## STANDARDS AND FEATURES

- 3-WAY SWITCH FOR HORSE AREA
- 30 AMP SERVICE w/DETACHABLE 30 AMP POWER CORD
- 60/40 REAR LOAD DOORS
- 6000# AXLES
- BRIDLE HOOKS
- DROP FEED WINDOWS
- DRP DWN ESCAPE DOOR WINDOW
- EXTERIOR WATER SPIGOT (N/A 6' LAYOUT)
- EXTRUDED ALUMINUM PLANK HORSE AREA FLOORING
- FIXED SADDLE TREE
- LED EXTERIOR LIGHTS
- LED LIGHTING THROUGHOUT
- LP TANKS (2) w/DUAL REGULATOR
- MANUAL JACK – SINGLE SPEED
- MICROWAVE
- NO HAY RACK
- ONE BATTERY, GRP 24 w/SHUT-OFF
- PORCELAIN TOILET
- REAR LOAD LIGHT (1)
- REFRIGERATOR
- RESIDENTIAL FAUCETS
- HIRT CLOSET(S) w/MIRRORED INSERTS IN BEDROOM
- SHOWER w/DUAL CONTROL HANDLES
- SKYLIGHT IN SHOWER
- SLIDING WINDOW ON HIP SIDE EACH STALL
- SPARE TIRE AND RIM
- ST235/80R16 LRE TIRES w/BLACK MOD STEEL WHEELS
- STEP (AT ENTRANCE DOOR)
- STAINLESS STEEL KITCHEN SINK
- TV/RADIO ANTENNA
- UPGRADED COUNTER TOP THROUGHOUT
- UPGRADED FLOOR COVERING THROUGHOUT
- UPGRADED GRAPHICS PACKAGE
- VINYL VALANCES w/MINI BLINDS
- WATER HEATER GAS DSI (6 GAL)
- WHITE EXTERIOR

SV708-SV708

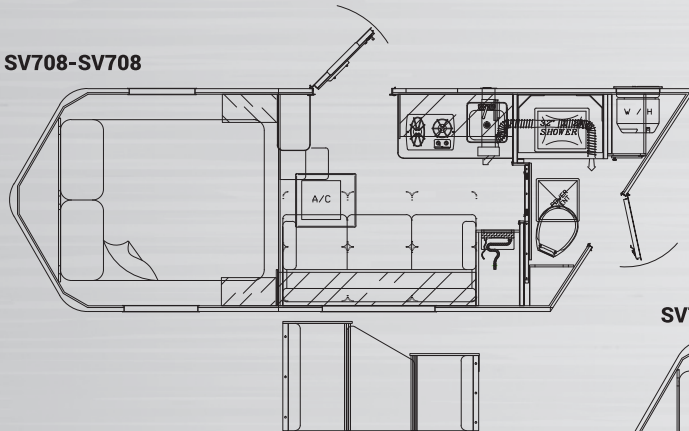

SV710-SV710

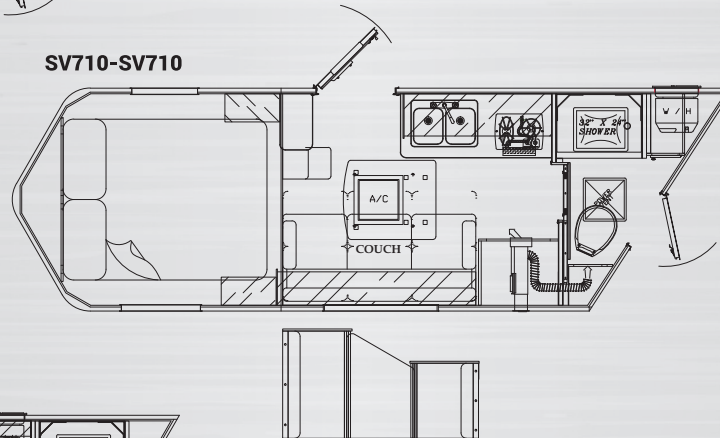

SV711-SV711

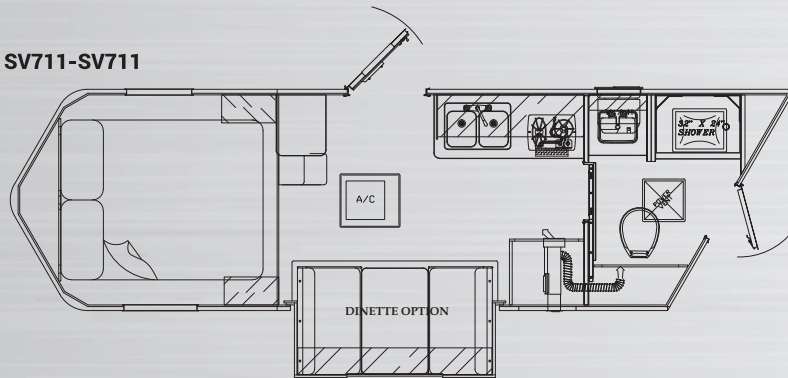



# 8' WIDE



## STANDARDS AND FEATURES

- 3-WAY SWITCH FOR HORSE AREA
- 30 AMP SERVICE w/DETACHABLE 30 AMP POWER CORD
- 60/40 REAR LOAD DOORS
- 7000# AXLES
- ADJUSTABLE SADDLE TREE
- ALUMINUM AIR FLOW DIVIDERS
- BRIDLE HOOKS
- BRITE NOSE - FRONT PANEL
- DROP DWN ESCAPE DOOR WINDOW
- DROP FEED WINDOWS
- EXTERIOR WATER SPIGOT (N/A 6' LAYOUT)
- EXTRUDED ALUMINUM PLANK HORSE AREA FLOORING
- FURNACE, 18,000 BTU
- GLASS SHOWER DOOR
- LED EXTERIOR LIGHTS
- LED LIGHTING THROUGHOUT
- LP TANKS (2) W/ DUAL REGULATOR
- MANUAL JACK- 2 SPEED
- MICROWAVE
- PORCELAIN TOILET
- RADIUS SHOWER W/DUAL CONTROL HANDLES
- REAR LOAD LIGHT (1)
- RECESSED COOK TOP W/ RANGE HOOD
- REFRIGERATOR
- RESIDENTIAL FAUCETS
- RV DOOR LATCH (@ ESCAPE DOOR)
- SHIRT CLOSET(S) W/MIRRORED INSERTS IN BEDROOM
- SINK COVERS
- SKYLIGHT IN SHOWER
- SLIDING WINDOW ON HIP SIDE EACH STALL
- ST235/85R16 LRG TIRES W/BLACK ALUM WHEELS
- STEP (AT ENTRANCE DOOR)
- SPARE TIRE & RIM
- STAINLESS STEEL KITCHEN SINK
- TV/RADIO ANTENNA
- TWO BATTERIES, GRP 24 W/ SHUT-OFF
- UPGRADED COUNTER TOP THROUGHOUT
- UPGRADED FLOOR COVERING THROUGHOUT
- UPGRADED GRAPHICS PACKAGE
- VINYL VALANCES W/ROLLER SHADES
- WATER HEATER GAS DSI (6 GAL)
- WHITE EXTERIOR
- XL TV UPGRADE (16' LIVING ENT. FLOORPLAN ONLY)

**RG809B-RG809B**

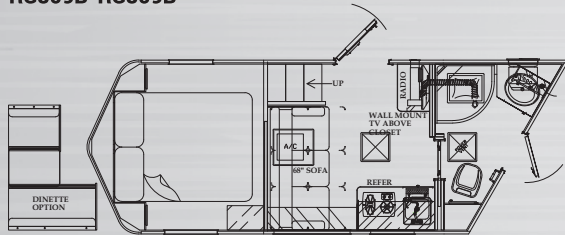

**RG811S-RG811S**

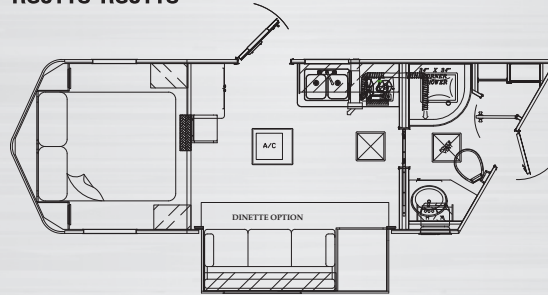

**RG811B-RG811B**

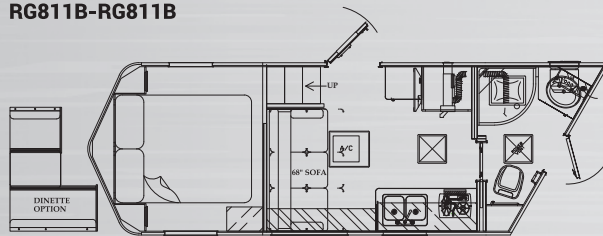

**RG813BS-RG813BS**

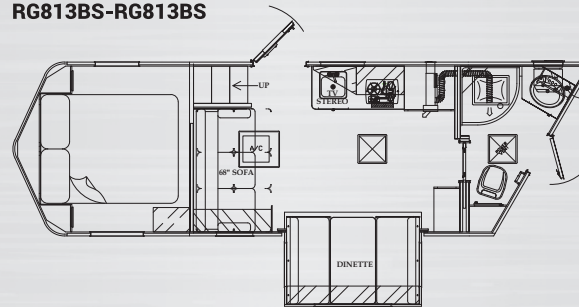

**RG813GS-RG813GS**

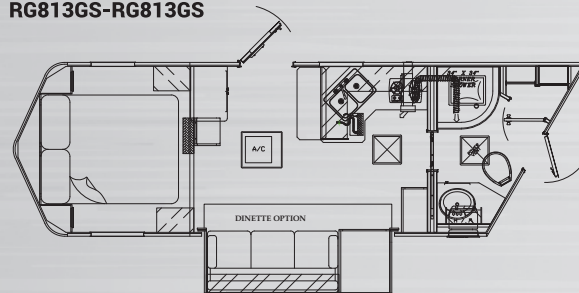

**RG816S-RG816**

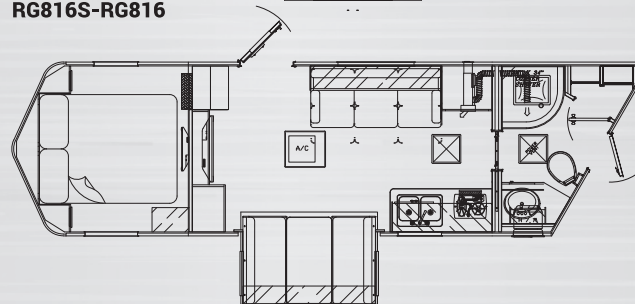



# 7' WIDE



## STANDARDS AND FEATURES

- 3-WAY SWITCH FOR HORSE AREA
- 30 AMP SERVICE w/DETACHABLE 30 AMP POWER CORD
- 60/40 REAR LOAD DOORS
- 6000# AXLES
- BRIDLE HOOKS
- DROP FEED WINDOWS
- DRP DWN ESCAPE DOOR WINDOW
- EXTERIOR WATER SPIGOT (N/A 6' LAYOUT)
- EXTRUDED ALUMINUM PLANK HORSE AREA FLOORING
- FIXED SADDLE TREE
- LED EXTERIOR LIGHTS
- LED LIGHTING THROUGHOUT
- LP TANKS (2) w/DUAL REGULATOR
- MANUAL JACK – SINGLE SPEED
- MICROWAVE
- NO HAY RACK
- ONE BATTERY, GRP 24 w/SHUT-OFF
- PORCELAIN TOILET
- REAR LOAD LIGHT (1)
- REFRIGERATOR
- RESIDENTIAL FAUCETS
- SHIRT CLOSET(S) w/MIRRORED INSERTS IN BEDROOM
- SHOWER w/DUAL CONTROL HANDLES
- SKYLIGHT IN SHOWER
- SLIDING WINDOW ON HIP SIDE EACH STALL
- SPARE TIRE AND RIM
- ST235/80R16 LRE TIRES w/BLACK MOD STEEL WHEELS
- STEP (AT ENTRANCE DOOR)
- STAINLESS STEEL KITCHEN SINK
- TV/RADIO ANTENNA
- UPGRADED COUNTER TOP THROUGHOUT
- UPGRADED FLOOR COVERING THROUGHOUT
- UPGRADED GRAPHICS PACKAGE
- VINYL VALANCES w/MINI BLINDS
- WATER HEATER GAS DSI (6 GAL)
- WHITE EXTERIOR

RG708-RG708

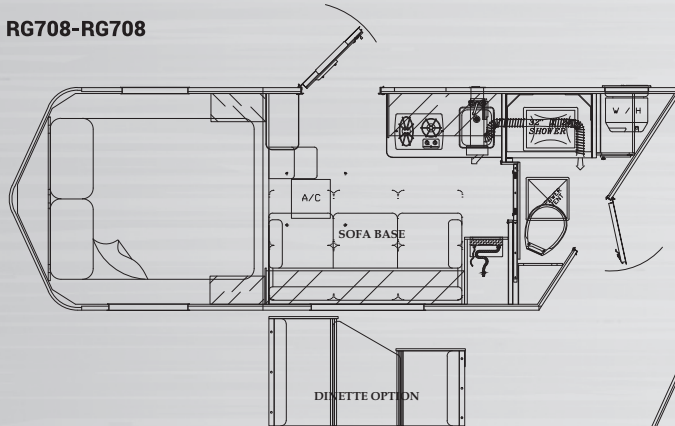

RG710-RG710

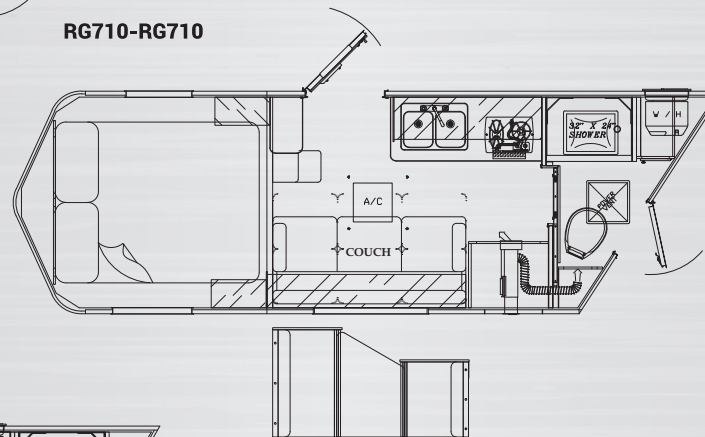

RG711-RG711

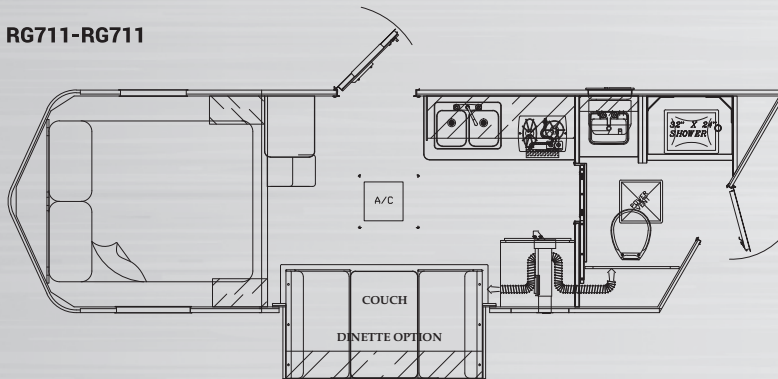

## SPECIFICATIONS

MODEL	OVERALL UNIT LENGTH	RISER WALL TO BACK LENGTH	EXTERIOR HEIGHT	INTERIOR HEIGHT	AXLE CAPACITY (LBS.)	GVWR	HITCH WEIGHT	UVW	FRESH WATER (GAL.)	GREY WATER (GAL.)	BLACK WATER (GAL.)
RG7208	28'-1"	20'-2 3/8"	109-3/4"	85-7/8"	6,000	14,577	2,577	7,787	39	35	35
RG7308	31'-5"	23'-6 3/8"	109-3/4"	85-7/8"	6,000	14,681	2,681	9,059	39	35	35
RG7408	34'-9"	26'-10 1/2"	109-3/4"	85-7/8"	6,000	14,439	2,439	9,099	39	35	35
RG7210	29'-2 1/2"	21'-3 7/8"	109-3/4"	85-7/8"	6,000	14,591	2,591	8,036	39	35	35
RG7310	32'-6 1/2"	24'-7 7/8"	109-3/4"	85-7/8"	6,000	14,463	2,463	8,632	39	35	35
RG7410	35'-10 1/2"	28'-0"	109-3/4"	85-7/8"	6,000	14,439	2,439	9,205	39	35	35
RG7211.S	31'-10 3/8"	23'-11 3/4"	109-3/4"	85-7/8"	6,000	15,248	3,248	8,207	39	35	35
RG7311.S	35'-2 3/8"	27'-3 3/4"	109-3/4"	85-7/8"	6,000	14,871	2,857	8,860	39	35	35
RG7411.S	38'-6 3/8"	30'-7 7/8"	109-3/4"	85-7/8"	6,000	15,014	3,014	9,779	39	35	35
RG8209B	29'-2"	21'-0 5/8"	109-3/4"	85-1/4"	7,000	17,153	3,153	8,996	39	35	35
RG8309B	32'-6"	24'-4 5/8"	109-3/4"	85-1/4"	7,000	16,415	2,915	9,289	39	35	35
RG8409B	35'-10"	27'-8 5/8"	109-3/4"	85-1/4"	7,000	16,754	2,754	10,324	39	35	35
RG8311B	34'-6 7/8"	26'-5 3/8"	109-3/4"	85-1/4"	7,000	17,035	3,035	9,805	39	35	35
RG8411B	37'-10 7/8"	29'-9 3/8"	109-3/4"	85-1/4"	7,000	17,071	3,071	10,700	39	35	35
RG8311.S	35'-7"	27'-5 5/8"	109-3/4"	85-1/4"	7,000	17,669	3,669	11,293	39	35	35
RG8411.S	38'-11"	30'-9 5/8"	109-3/4"	85-1/4"	7,000	17,442	3,442	12,082	39	35	35
RG8313B.S	37'-0 7/8"	28'-11 3/8"	109-3/4"	85-1/4"	7,000	16,961	2,961	9,868	39	35	35
RG8413B.S	40'-4 7/8"	32'-3 3/8"	109-3/4"	85-1/4"	7,000	17,408	3,408	11,938	39	35	35
RG8313G.S	36'-9"	28'-7 1/2"	109-3/4"	85-1/4"	7,000	17,569	3,569	11,079	39	35	35
RG8413G.S	40'-1"	31'-11 1/2"	109-3/4"	85-1/4"	7,000	17,621	3,621	12,096	39	35	35
RG8316.S	39'-9 1/2"	31'-8"	109-3/4"	85-1/4"	7,000	17,668	3,668	11,798	39	35	35
RG8316R.S.L	41'-11 7/8"	33'-10 3/8"	109-3/4"	85-1/4"	7,000				39	35	35
RG8416.S	43'-1 1/2"	35'-0"	109-3/4"	85-1/4"	8,000	17,819	3,819	12,194	39	35	35
RG8416R.S.L	45'-1 7/8"	37'-0 1/2"	109-3/4"	85-1/4"	8,000				39	35	35
SV7208	28'-3 1/2"	19'-11 1/4"	109-3/4"	85-7/8"	6,000	14,403	2,403	6,618	39	35	35
SV7308	31'-7 1/2"	23'-3 1/4"	109-3/4"	85-7/8"	6,000	14,457	2,457	7,234	39	35	35
SV7408	34'-11 3/4"	26'-7 1/2"	109-3/4"	85-7/8"	6,000	14,499	2,499	7,472	39	35	35
SV7210	29'-5"	21'-0 3/4"	109-3/4"	85-7/8"	6,000				39	35	35
SV7310	32'-9"	24'-4 3/4"	109-3/4"	85-7/8"	6,000	14,513	2,513	7,486	39	35	35
SV7410	36'-1 1/4"	27'-9"	109-3/4"	85-7/8"	6,000	14,714	2,714	7,934	39	35	35
SV7211.S	32'-0 3/4"	23'-8 1/2"	109-3/4"	85-7/8"	6,000				39	35	35
SV7311.S	35'-4 3/4"	27'-0 1/2"	109-3/4"	85-7/8"	6,000	14,914	2,914	8,414	39	35	35
SV7411.S	38'-9"	30'-4 3/4"	109-3/4"	85-7/8"	6,000	14,936	2,935	8,638	39	35	35
SV8209B	29'-4 1/8"	21'-2 5/8"	109-3/4"	85-1/4"	7,000	16,733	2,933	7,692	39	35	35
SV8309B	32'-3 1/8"	24'-1 5/8"	109-3/4"	85-1/4"	7,000	16,674	2,674	8,239	39	35	35
SV8409B	35'-7 1/8"	27'-5 5/8"	109-3/4"	85-1/4"	7,000	16,811	2,811	9,064	39	35	35
SV8311B	34'-4"	26'-2 1/2"	109-3/4"	85-1/4"	7,000	16,844	2,844	8,619	39	35	35
SV8411B	37'-8"	29'-6 1/2"	109-3/4"	85-1/4"	7,000	17,125	3,125	10,178	39	35	35
SV8311.S	35'-4 1/4"	27'-2 3/4"	109-3/4"	85-1/4"	7,000	17,311	3,311	9,626	39	35	35
SV8411.S	38'-8 1/4"	30'-6 3/4"	109-3/4"	85-1/4"	7,000	17,483	2,983	9,483	39	35	35
SV8313B.S	36'-9 7/8"	28'-8 3/8"	109-3/4"	85-1/4"	7,000	17,290	3,290	9,638	39	35	35
SV8413B.S	40'-2"	32'-0 1/2"	109-3/4"	85-1/4"	7,000	17,872	3,372	10,402	39	35	35
SV8313G.S	36'-6"	28'-4 1/2"	109-3/4"	85-1/4"	7,000	17,568	3,568	10,493	39	35	35
SV8413G.S	39'-10"	31'-8 1/2"	109-3/4"	85-1/4"	7,000	17,431	3,431	10,254	39	35	35
SV8316.S	39'-6 5/8"	31'-5 1/8"	109-3/4"	85-1/4"	7,000	18,118	3,618	10,327	39	35	35
SV8316R.S.L	41'-10 3/4"	33'-9 1/4"	109-3/4"	85-1/4"	7,000	17,401	3,401	10,741	39	35	35
SV8416.S	42'-10 5/8"	34'-9 1/8"	109-3/4"	85-1/4"	8,000	17,129	3,729	10,992	39	35	35
SV8416R.S.L	45'-0 3/4"	36'-11 1/4"	109-3/4"	85-1/4"	8,000	17,033	3,033	10,868	39	35	35

Due to our constant product improvements, and changes in specifications, component parts and standard/optional equipment, all Bison's products are subject to change without notice or obligation. Product photography or diagrams may show equipment that is optional. We reserves the right to make changes in pricing and models and to discontinue models without notice or obligation. Components, parts or chassis may have been manufactured at times other than the model year indicated. All capacities are approximate and dimensions are nominal. All dry weights are based on standard models with basic features and do not include optional features or equipment. Various components and features may differ to conform to local codes. The individual manufacturers and not Bison warrant appliances and other components.

COPYRIGHT © 2022 · BISON TRAILERS · ALL RIGHTS RESERVED



**BISON ... Better Than Ever!**

1002 N. Old St Rd 15 | Milford, IN 46542  
 Phone 574.658.4161 | Fax 574.658.4476  
[bisontrailer.com](http://bisontrailer.com)



YOUR LOCAL BISON DEALER