

# Bison

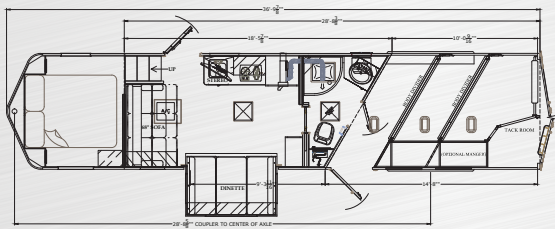

# SILVERADO





SV8313B.S (SILVERADO)

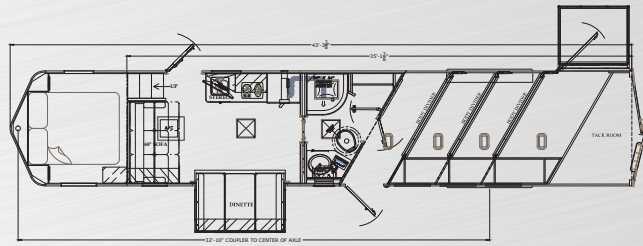

SV8415B.S.R (SILVERADO)

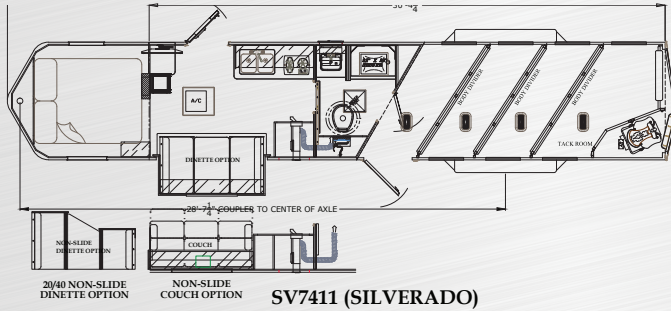

SV7411 (SILVERADO)

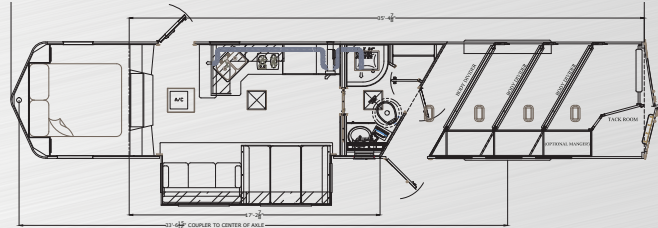

SV8417.S (SILVERADO)

### STANDARD FEATURES:

- Drop Down Window in Escape Door
- 30 Amp Service W/ Detachable 30 Amp cord
- 30 x 24 Slider Tail side
- 30X24 Drop Down feeder Head side
- 3-Way Switch in Horse Area
- 60/40 Rear Load Doors
- 6K, 7K & 8K Axles available
- Aluminum Air Flow Dividers
- Bridle Hooks
- Drop in Cook Top
- Exterior Water Spigot
- Fixed Saddle Tree(7W), adjustable(8W)
- Led Exterior Lights
- Led Lighting Throughout
- LP Tanks (2) W/ Dual Regulator
- Manual Jack
- Microwave
- Plastic Toilet
- Mini Blind with valance duplicate
- Battery/Batteries, Grp 24 W/ Shut-Off
- Rear Load Light (1)
- Refrigerator (3, 6, 8 CF)
- Residential Faucets
- Shirt Closet(S)
- Shower Curtain
- Shower W/Dual Control Handles
- Solar Ready
- Stainless Steel Kitchen Sink
- Step (At Entrance Door)
- TV/Radio Antenna
- Mini Blind or Roller Shade w/ Valance
- Water Heater Gas DSI (6 Gal)
- White Exterior
- Entertainment Center (standard on 16' & 17' LQ)

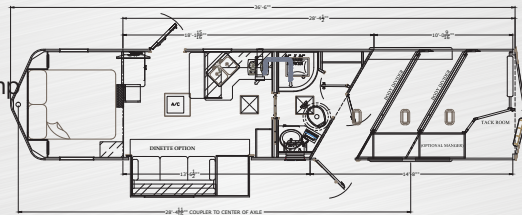

SV8313G.S (SILVERADO)

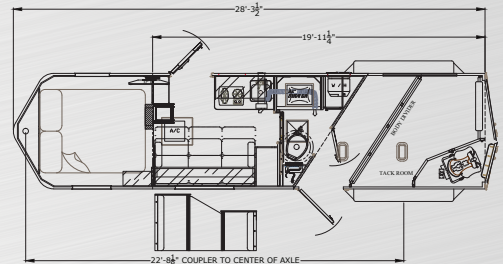

SV7208 (SILVERADO)

### OPTIONS:

#### TRAILER OPTIONS

- 4500W Generator W/ Fuel Tank
- 2nd Battery, GRP 24 W/ Shut-Off
- Upgraded Axles and Tires
- Hydraulic Jack(s)
- Aluminum Rear Ramp
- Aluminum Rear Side Load
- Tank Heater Blanket
- Load Light Pkg. (4 Total)
- Clearance Lights
- Exterior Color Option – Charcoal and Silver
- Brite Nose
- Extruded alum. full or horse area only
- Exterior BBQ Outlet
- Exterior Spray Port
- Awning, Powered W/Led Light Strip

#### HORSE AREA

- AC ducted to Horse Area
- Hay Rack or Hay Pod
- HD Drop Down Windows
- HD Kick-Wall & Horse Door Liner
- Horse Fans (Per Stall)
- Lined & Insulated Horse Area Ceiling
- Manger
- RV Door Latch (Escape Door)
- Stud Wall
- Step @ Escape
- Swing out Saddle Bar

- Swing out Blanket Bar
  - Adjustable Saddle Tree (Std on 8W)
- #### LIVING QUARTERS
- 13,500 BTU Air Cond., Non-Ducted
  - 15K or 18K BTU Air Cond. Ducted
  - 32" LCD TV W/ Locking Swing Arm
  - Cable Inlet
  - Countertop Extension
  - Dinette/Sofa option
  - Countertop Extension
  - Fantastic Fan
  - Fireplace (16' & 17' LQ only)
  - Free-Standing Table
  - Interior options: Graphite or Rustic
  - Décor Package
  - Queen Mattress W/ Cover
  - Recessed Cook Top
  - Water Heater Gas/Electric DSI – 6 Gal.
  - 190 W Solar System
  - Hat Rack
  - Stereo (Car Play Option)
  - 3 Burner Oven
  - Convection Microwave
  - Ceramic Toilet
  - Theater Seating

*Please note: The above list represents common options and is subject to change. If you are looking for a particular option not listed, please do not hesitate to ask.*



**Bison Trailers, LLC**  
 1002 N. Old St. Rd 15  
 Milford, IN 46542  
 Sales@Bisontrailer.com  
 www.Bisontrailer.com