

Bison

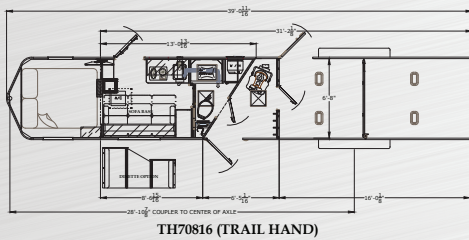

TRAIL HAND





TH70816 (TRAIL HAND)

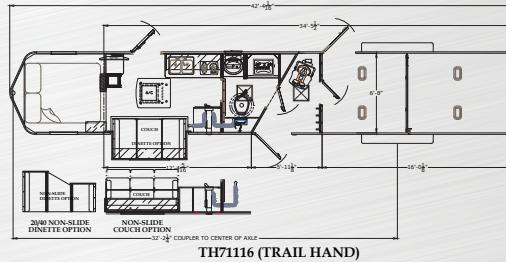

TH71116 (TRAIL HAND)

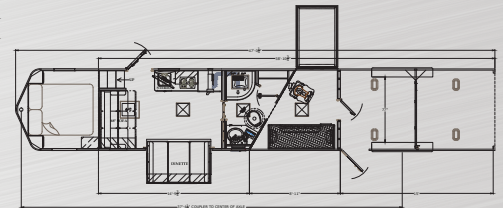

TH81515B.S (TRAIL HAND)

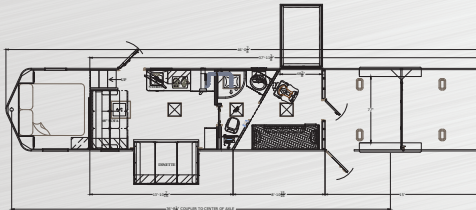

TH81315B.S (TRAIL HAND)

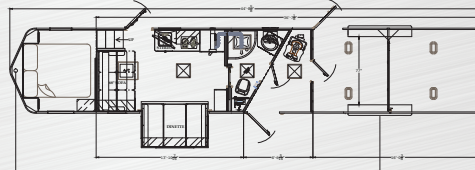

TH81516B.S (TRAIL HAND)

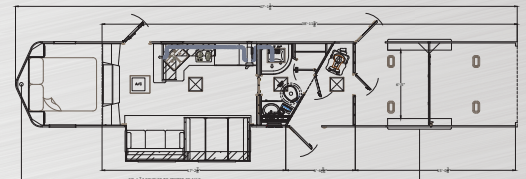
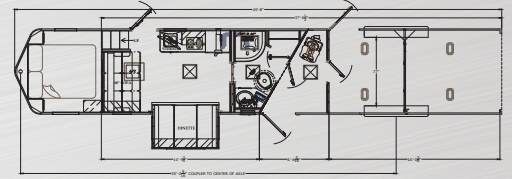

TH81715.S (TRAIL HAND)

STANDARD FEATURES:

- 30 Amp Service W/ Detachable 30 Amp cord
- 3-Way Switch in Horse Area
- 50/50 Rear Load Doors
- 7K & 8K Axles available
- Bridle Hooks
- Drop in Cook Top
- Entertainment Center (Standard on 17' LQ)
- Exterior Water Spigot (NA on 6'LQ)
- Led Exterior Lights
- Led Lighting Throughout
- LP Tanks (2) W/ Dual Regulator
- Manual Jack
- Microwave
- Mini Blind with valance
- Battery/Batteries, Grp 24 W/ Shut-Off
- Plastic Toilet
- Rear Load Light (1)
- Refrigerator (3, 6, 8 CF)
- Residential Faucets
- Rubber Matting in Mid-tack & Stock Area
- Saddle Tree in Mid-Tack
- Shirt Closet(S)
- Curtain/ Radius Shower
- Shower W/Dual Control Handles
- Solar Ready
- Stainless Steel Kitchen Sink
- Step (At Entrance Door)
- TV/Radio Antenna
- Water Heater Gas DSI (6 Gal)
- White Exterior

OPTIONS:

TRAILER OPTIONS

- 4500W Generator W/ Fuel Tank
- 2nd Battery, GRP 24 W/ Shut-Off
- Upgraded Axles and Tires
- Hydraulic Jack(s)
- Aluminum Rear Ramp
- Awning, Powered W/Led Light Strip
- Exterior Color Option – Charcoal and Silver
- Brite Nose
- Clearance Lights
- Extruded Aluminum - Full Extrusion
- Exterior BBQ Outlet
- Exterior Spray Port W/Quick Disconnect Hose
- Load Light Pkg. (4 Total)
- TPMS – Trailer Pressure Monitoring System
- Tank Heater Blanket

HORSE AREA

- Hay Rack or Hay Pod
- HD Kick-Wall
- Horse Fans (Per Stall)
- Lined & Insulated Horse Area Ceiling
- Step @ Escape

LIVING QUARTERS

- 13,500 BTU Air Cond., Non-Ducted
- 15,000 BTU Air Cond. Ducted
- 32" TV in entertainment center/bed-room side
- Bunk Beds in Mid – Tack where applicable
- Bunk Privacy Curtain
- Cable Inlet
- Ceramic Toilet
- Convection Microwave

- Countertop Extension
- Décor Package
- Dinette/Sofa option
- Rear Load Light (1)
- Fantastic Fan
- Fireplace (16' & 17" LQ)
- Furnace, 18,000 BTU
- Hat Rack
- Interior options: Graphite or Rustic
- Oven W/3 Burner Stove Top
- Queen Mattress W/cover
- Recessed Cook Top
- Slide out on 11' and larger
- Solar System – 190W
- Stereo (Car Play option available)
- Theater Seating
- Water Heater Gas/Electric DSI – 6 Gal.

Please note: The above list represents common options and is subject to change. If you are looking for a particular option not listed, please do not hesitate to ask.



Bison Trailers, LLC

1002 N. Old St. Rd 15
 Milford, IN 46542
 Sales@Bisontrailer.com
 www.Bisontrailer.com